



Keystone DIN-Rail Adapter for RJ45 Module

Technical Features

For one RJ45 keystone module

Fits into standard 35mm DIN rail

ABS housing; Light grey

With shield plate (grounding)

Keystone Port: 16.3 x 15mm

Stackable

Technical Drawings

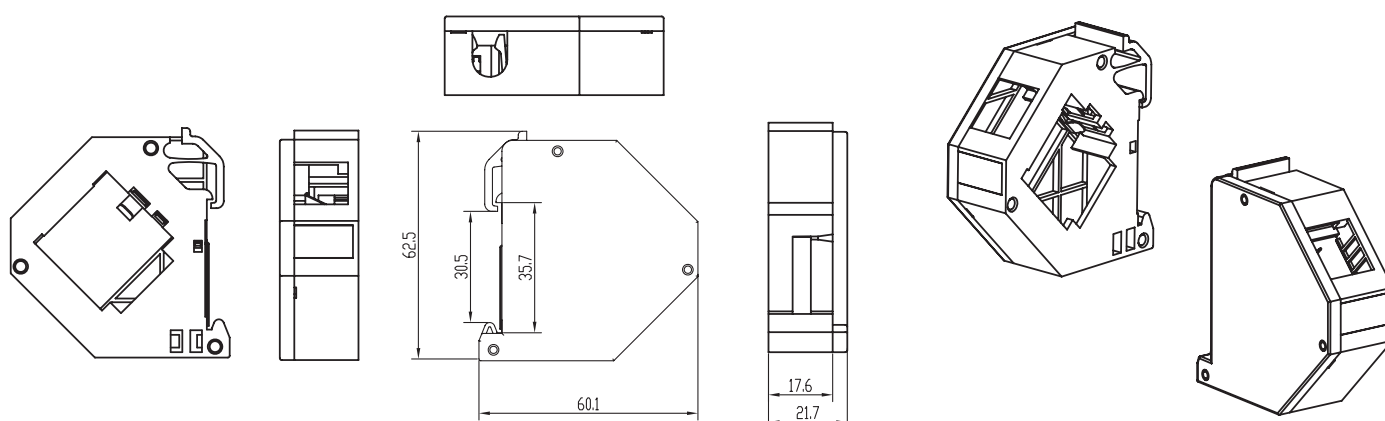

RoHS
compliant



* The specifications and pictures are subject to change without notice.
*All trade names referenced are the registered namework of their respective owners.

DIN-Rail Adapters

Package Contents

Keystone DIN-Rail Adapter for RJ45 Module x1

Packaging Informations

Packing Dimension	120 x 90 x 25mm
Packing Weight	0.03kg
Carton Dimension	500 x 370 x 270mm
Carton Q'ty	300pcs
Carton Weight	8.4kg

